



CST ENERGY



25.6V 100Ah LiFePO₄ Battery

FEATURES & BENEFITS



High cycle life

>3000 cycles @80% DoD for effectively lower total cost of ownership.



Built in circuit protection

Battery Management Systems (BMS) are incorporated against abuse.



Light weight

Lithium batteries provide more Wh/Kg while also being up to 1/3 the weight of its SLA equivalent



Extreme heat tolerance

Suitable for use in a wider range of applications where ambient temperature is unusually high: up to +60°C.



Longer service life

Low maintenance batteries with stable chemistry. Easily monitor state of charge (SoC) of smart models.



Better storage

Up to 6 months thanks to its extremely low self discharge (LSD) rate and no risk of sulphation.



Quickly recharge

Save time and increase productivity with less down time thanks to superior charge/discharge efficiency.



Leading technology

We are a lithium battery brand originating from Germany and holding German patent certification

PERFORMANCE CHARACTERISTICS

Battery Capacity & Discharge Rate

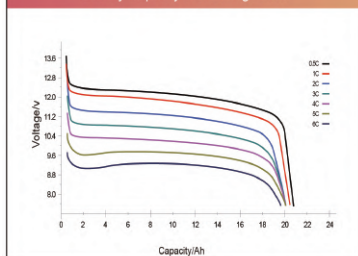

Discharge Curves Under Different Temperatures

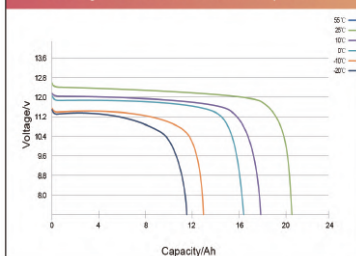

Cycle Life & Capacity @ Li-ion Battery(8k)Cycles

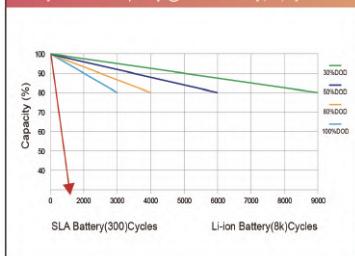

0.2C CC-Cv Charge Characteristics

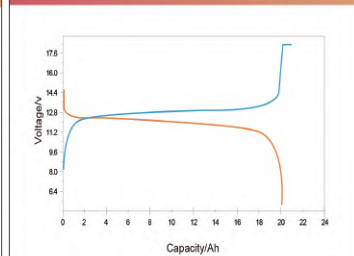



CST ENERGY

MODEL:CST-LT-25.6-100

ELECTRICAL PERFORMANCE

Nominal Voltage	25.6V
Nominal Capacity	100Ah
Energy	2560Wh
Resistance	$\leq 10\text{m}\Omega @ 50\%\text{SOC}$
Self Discharge	$< 3\% / \text{Month}$
Life Cycle	$> 3000\text{Cycles}$

DISCHARGE PERFORMANCE

Continuous Discharge Current	50A
Maximum continuous Discharge Current	100A
Discharge Cut-Off Current	300A(100mS)
Recommended Low Voltage Disconnect	20V
Discharge Cut-Off Voltage	$< 18.4\text{V}$
Reconnect Voltage	22.4V
Short Circuit Protection	Yes

CHARGE PERFORMANCE

Recommended Charge Current	50A
Maximum Charge Current	100A
Recommended Charge Voltage	28.8V
Charge Cut-Off Voltage	29.6V
Reconnect Voltage	$> 28\text{V}$
Balancing Voltage	$< 28.4\text{V}$

MECHANICAL PERFORMANCE

Dimension (L x W x H)	194x384x254mm
Net. Weight	20.3kg
Terminal Type	M8
Case Material	ABS
Enclosure Protection	IP65

TEMPERATURE PERFORMANCE

Discharge Temperature	$-20 \sim 55^{\circ}\text{C}$
Charge Temperature	$0 \sim 55^{\circ}\text{C}$
Storage Temperature	$-20 \sim 25^{\circ}\text{C}$
High Temperature Cut-Off	$75 \pm 5^{\circ}\text{C}$
Reconnect Temperature	$53 \pm 10^{\circ}\text{C}$

COMPLIANCE

Certifications	UL CE UN38.3
Shipping Classification	UN 3480,MSDS



OUTLINE DIMENSION

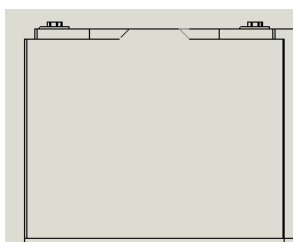

L:194mm

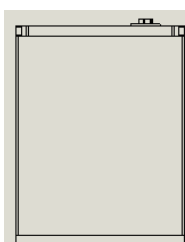

H:254mm

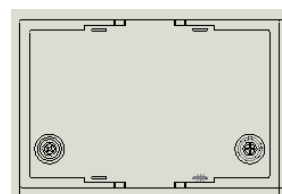

W:384mm